

vitrina™

Wall Display Cases



vitrina™

Wall Display Cases

Providing a versatile and secure option for your information display needs, Vitrina™ lockable, wall display cases are slimline in design and easily wall mounted onto a range of surface materials.



1 Secure, lockable front panels. Units are supplied with 2 keys.



2 Slimline, silver anodised aluminium frame.



3 SCXS and SCE economy units feature safety corners.

SCXS - Indoor



Lockable economy wall display case for indoor use.

- Manufactured with a steel whiteboard panel for use with marker pens and magnets.
- Attractive silver anodised aluminium frame.
- Slimline 26mm profile.
- Features rounded, safety corners and acrylic door.
- **Other sizes available to order.**
*Minimum order quantity applies.



Specifications		X×Y	A×B
SCXS2xA4	1x2 = 2xA4	440x310 mm	491x350 mm
SCXS3xA4	1x3 = 3xA4	660x310 mm	711x350 mm
SCXS4xA4	2x2 = 4xA4	440x615 mm	491x655 mm
SCXS6xA4	2x3 = 6xA4	660x615 mm	711x655 mm
SCXS9xA4	3x3 = 9xA4	660x923 mm	711x963 mm
SCXS12xA4	3x4 = 12xA4	880x923 mm	931x963 mm

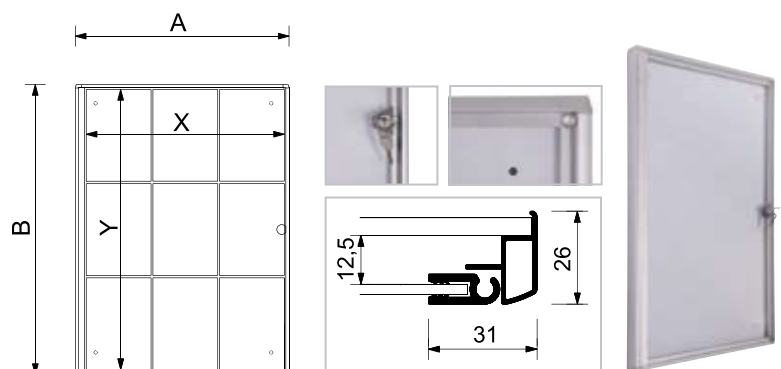

SCE - Indoor/Outdoor



Lockable economy wall display case for indoor and covered outdoor use.

- Manufactured with a steel whiteboard panel for use with magnets.
- Attractive silver anodised aluminium frame with hinged front door.
- Features ESG safety glass and safety corners.
- **Other sizes available to order.** *Minimum order quantity applies.



Specifications		X×Y	A×B
SCE8xA4PH	4x2 = 8xA4	901x636 mm	741x1003 mm

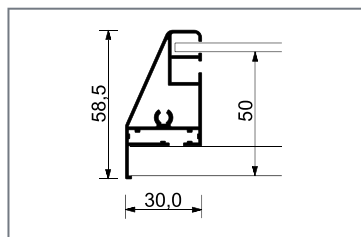
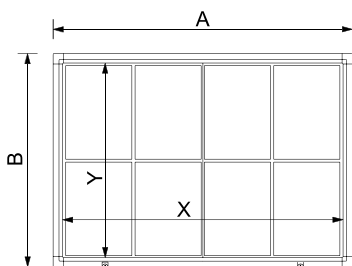

SCS - Indoor/Outdoor



Lockable wall display case for indoor and covered outdoor use.

- Manufactured with a steel whiteboard panel for use with dry wipe marker pens and magnets.
- 23mm slimline, silver anodised aluminium frame.
- Features UV resistant acrylic door.
- Supplied with 2 keys.



Specifications		X×Y	A×B
SCS2xA4	2x1 = 2xA4	440x308 mm	521x388 mm
SCS3xA4	3x1 = 3xA4	660x308 mm	741x388 mm
SCS4xA4	2x2 = 4xA4	440x615 mm	521x696 mm
SCS6xA4	3x2 = 6xA4	660x615 mm	741x696 mm
SCS8xA4	4x2 = 8xA4	880x615 mm	961x696 mm
SCS9xA4	3x3 = 9xA4	660x922 mm	741x1004 mm
SCS12xA4	4x3 = 12xA4	880x922 mm	961x1004 mm

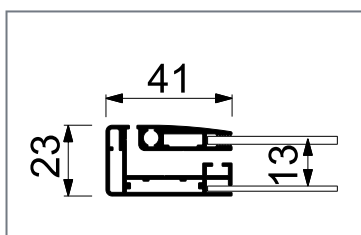
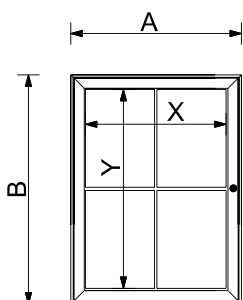

vitrina™ Wall Display Cases

SCZ2 - Outdoor Wall Display Case



Lockable wall display case suitable for indoor and outdoor use.

- Lockable wall display case to suit 2 x A4 pages.
- Features magnetic backboard and logo topper, which you can customise to suit your branding requirement.
- Polycarbonated door.
- **Other sizes available to order.** *Minimum order quantity applies.



Specifications

		X×Y	A×B
SCZ2xA4	2x1 = 2xA4	435x307 mm	505x477 mm

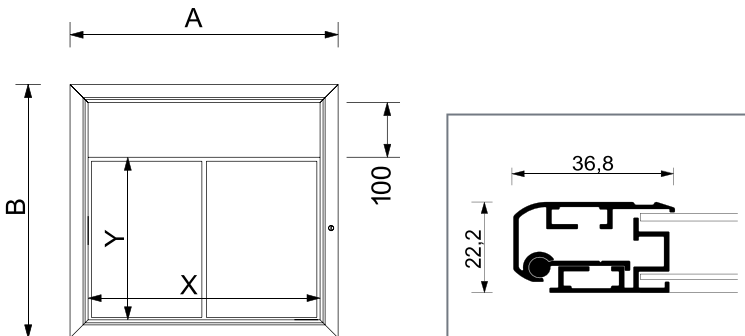

SCZ2xA4 - LED Wall Display Case



Lockable, illuminated wall display case suitable for indoor and outdoor use.

- 12/24V LED wall display case to suit 2 x A4 pages.
- Features magnetic backboard and logo topper, which you can customise to suit your branding requirement.
- Polycarbonated door.
- **Other sizes available to order.** *Minimum order quantity applies.

Specifications

		X×Y	A×B	
SCZ2xA4LED	2x1 = 2xA4	435x307 mm	505x477 mm	2,4 W

